

Fellowship Hall

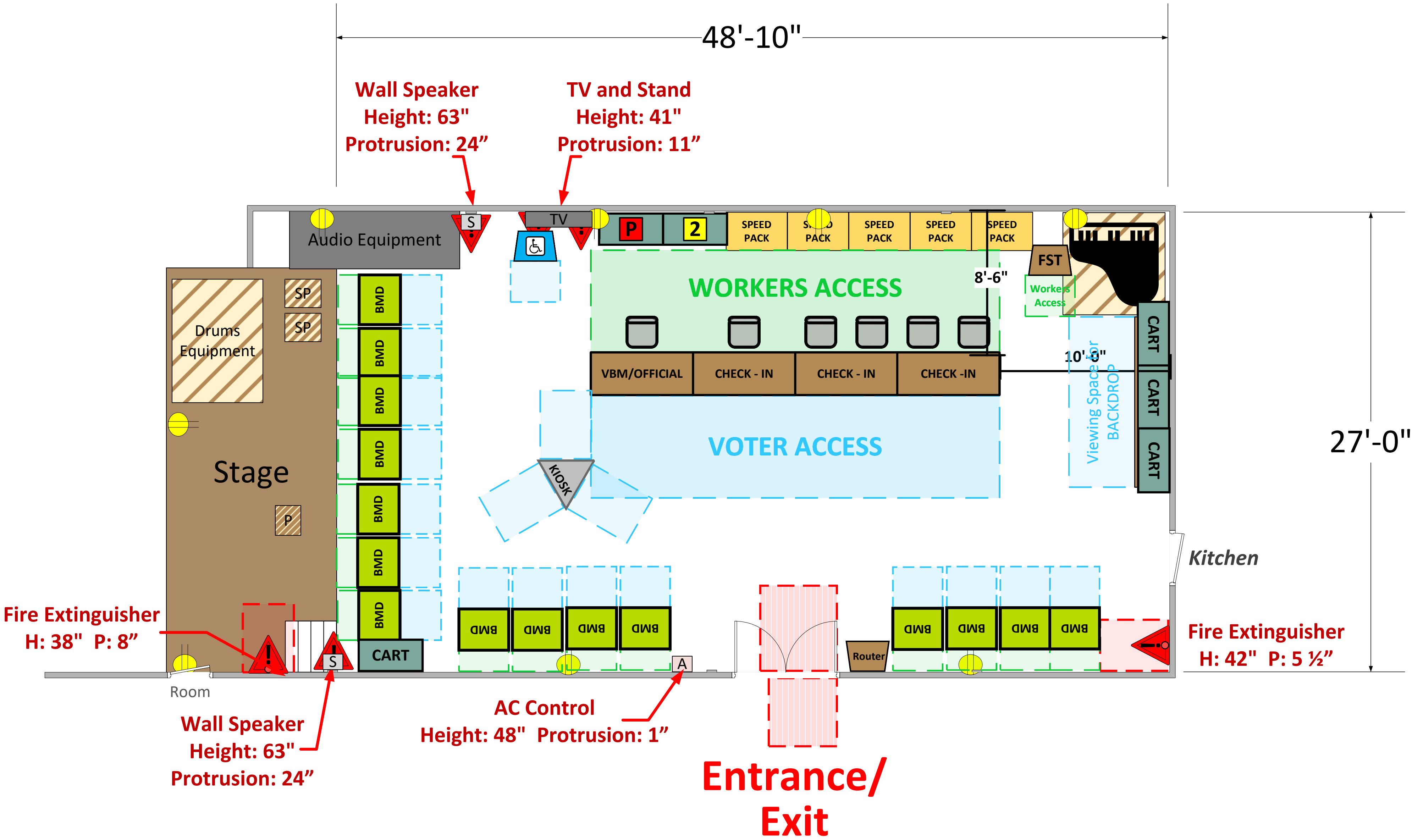

(1,495 Usable Sq. Ft.)

Table must be moved out of Room

Table



LEGEND

Room Size	Dimension: 48'10" x 26'7"	Sq. Ft: 1,495'
Number of BMDs		
POWER OUTLET		
PROTRUDING OBJECT		
Do Not Block Area		
TITLE		
VCID 11790		
Tree of Life Baptist Church		

Equipment By:	Date:
Ryan Rivas	08/27/24
Skeleton Drawn By:	Date:
David Chaparro	08/27/24
Scale:	
1 1/4" inches = 1' Ft.	

Each chair at a CHECK-IN station equals one ePollbook