

Dr. Ernest Shaw Boardroom

(1,277 Sq. Ft.)

Covid
Plastic
Dividers

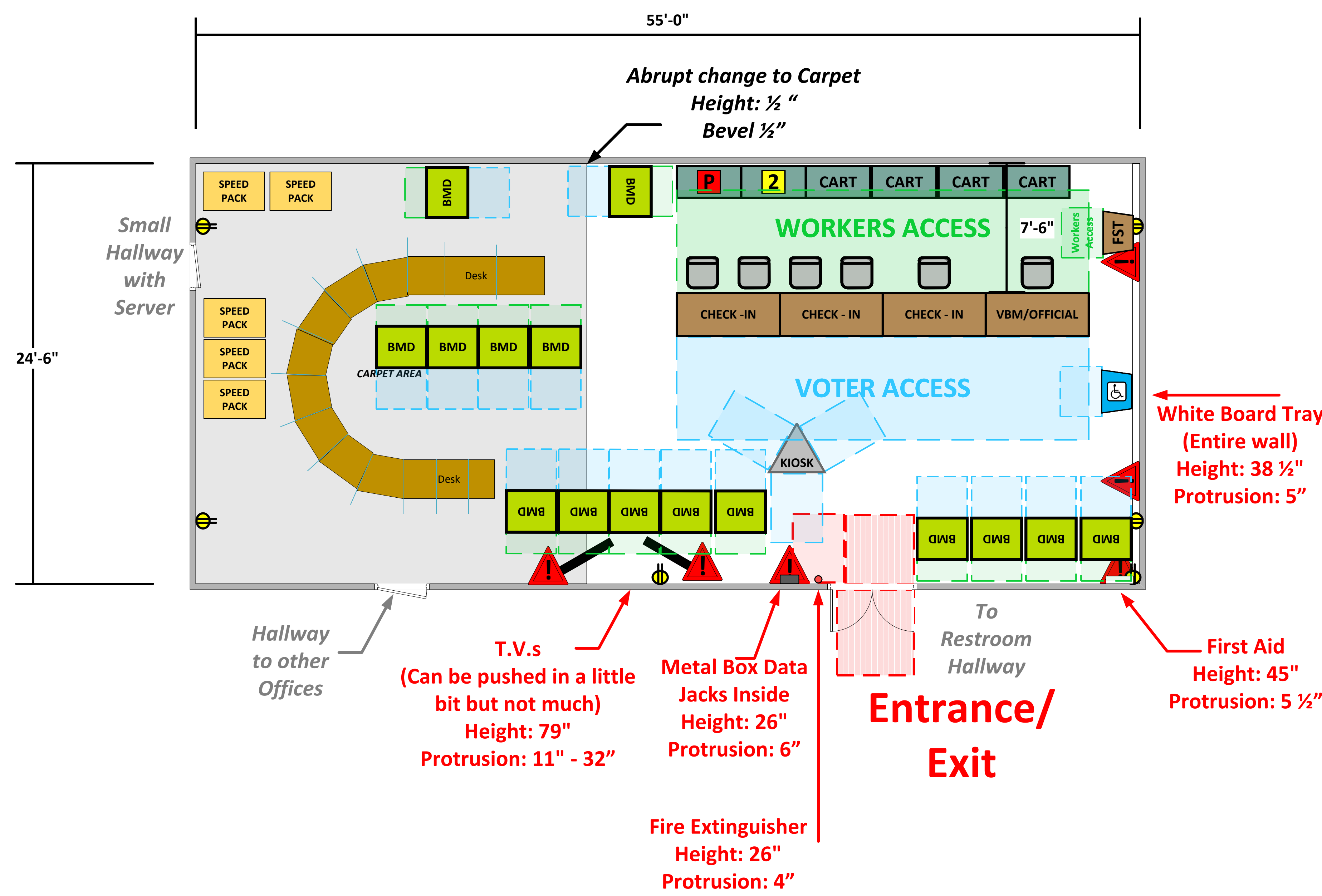

LEGEND

Room Size	Dimension: 24'6" x 55'	Sq. Ft: 1,277
Number of BMDs	15	
POWER OUTLET		
PROTRUDING OBJECT		
Do Not Block Area		

TITLE

VCID 14195
Inglewood Unified School District

Each chair at a CHECK-IN station equals one ePollbook

Equipment By: Jaime Young	Date:
Skeleton Drawn By: Jonathan Gonzalez	Date: 09/06/24
Scale: 1 1/4" inches = 1' Ft.	