

Auditorium & Stage (2,217 Usable Sq. Ft.)

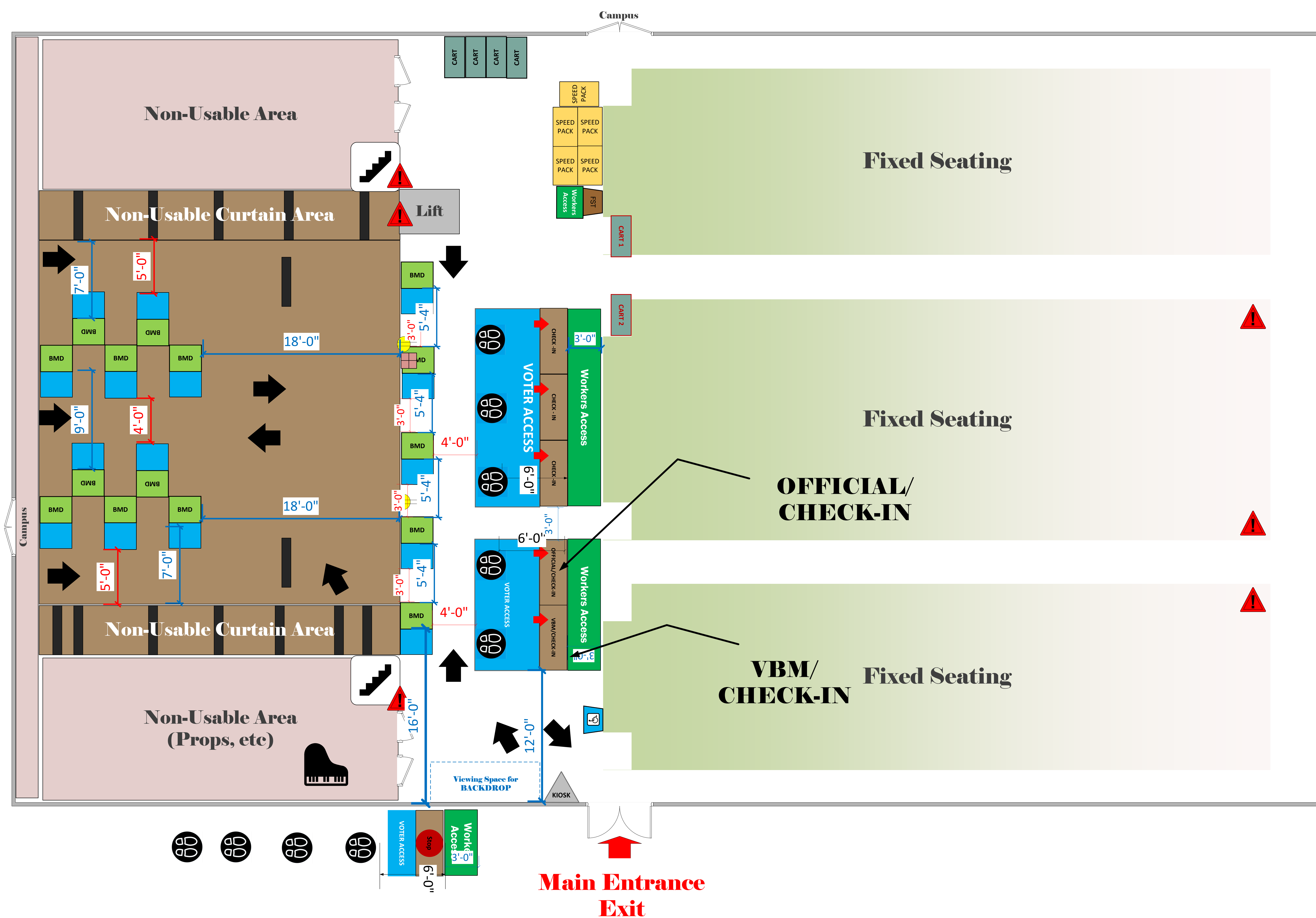
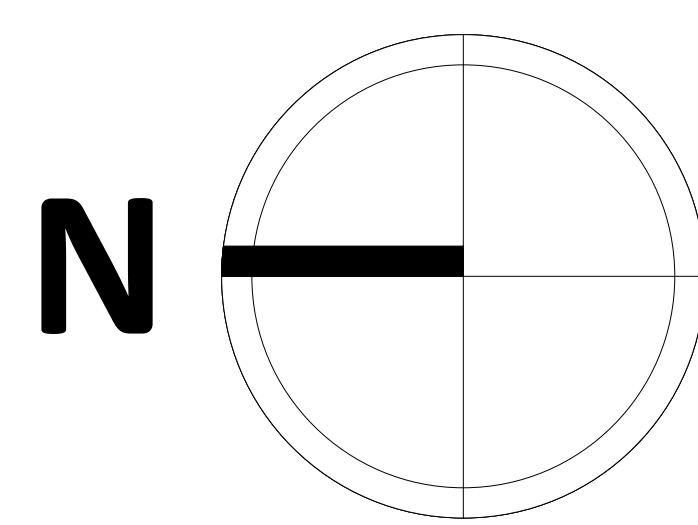

LEGEND

Room Size	Dimension:	Sq. Ft:	2217
EPB	Primary:	Secondary:	
BMD	Total: 15	Actual: 15	
Circuits	Total:	Usable:	
Floor Details			
BALLOT MARKING DEVICE			
CHECK IN TABLE			
BMD CART			
BACKDROP			
KIOSK			
POWER OUTLET			
PROTRUDING OBJECT			
ROUTER			
POWER CORDS			

TITLE **George Washington
Carver Middle School
VC ID#14339**

SCALE	1: 48
DRAWN BY	Ryan Rivas