

**Lobby**  
**(1,501 Sq. Ft.)**

**18'-7"**  
**Conference Room**  
**(161 Sq Ft)**

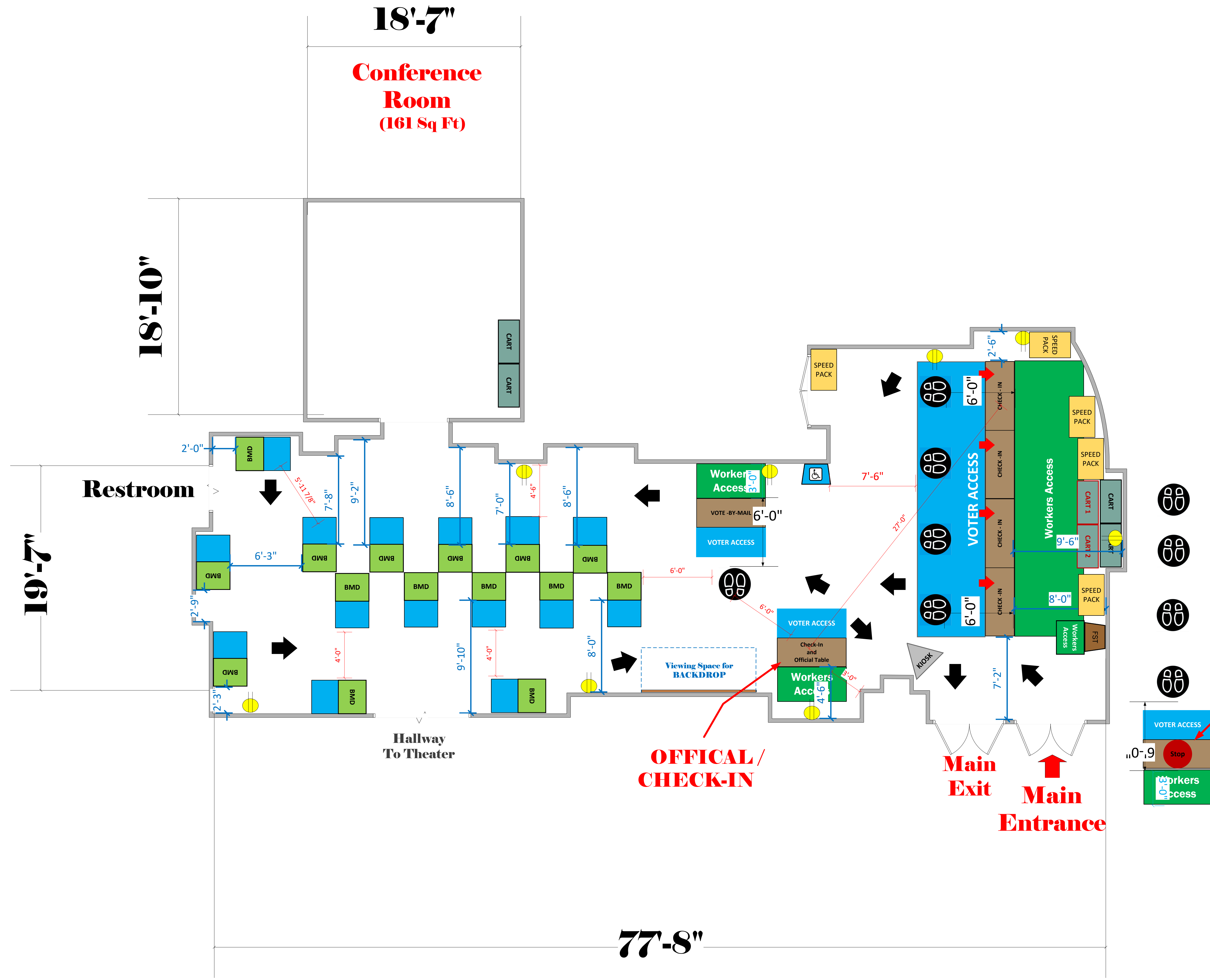
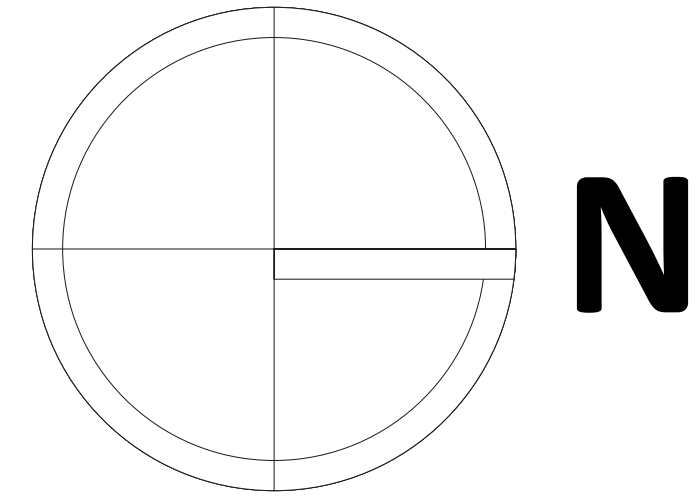

**LEGEND**

Room Size	Dimension: 77'8" x 19'7"	Sq. Ft: 1,501'
EPB	Primary:	Secondary:
BMD	Total: 15	Actual:
Circuits	Total:	Usable:
Floor Decals		
BALLOT MARKING DEVICE		
CHECK IN TABLE		
BMD CART		
BACKDROP		
KIOSK		
POWER OUTLET		
PROTRUDING OBJECT		
ROUTER		
POWER CORDS		

TITLE  
**Baldwin Park**  
**Performing Arts Center**  
**VC ID# 15011**