

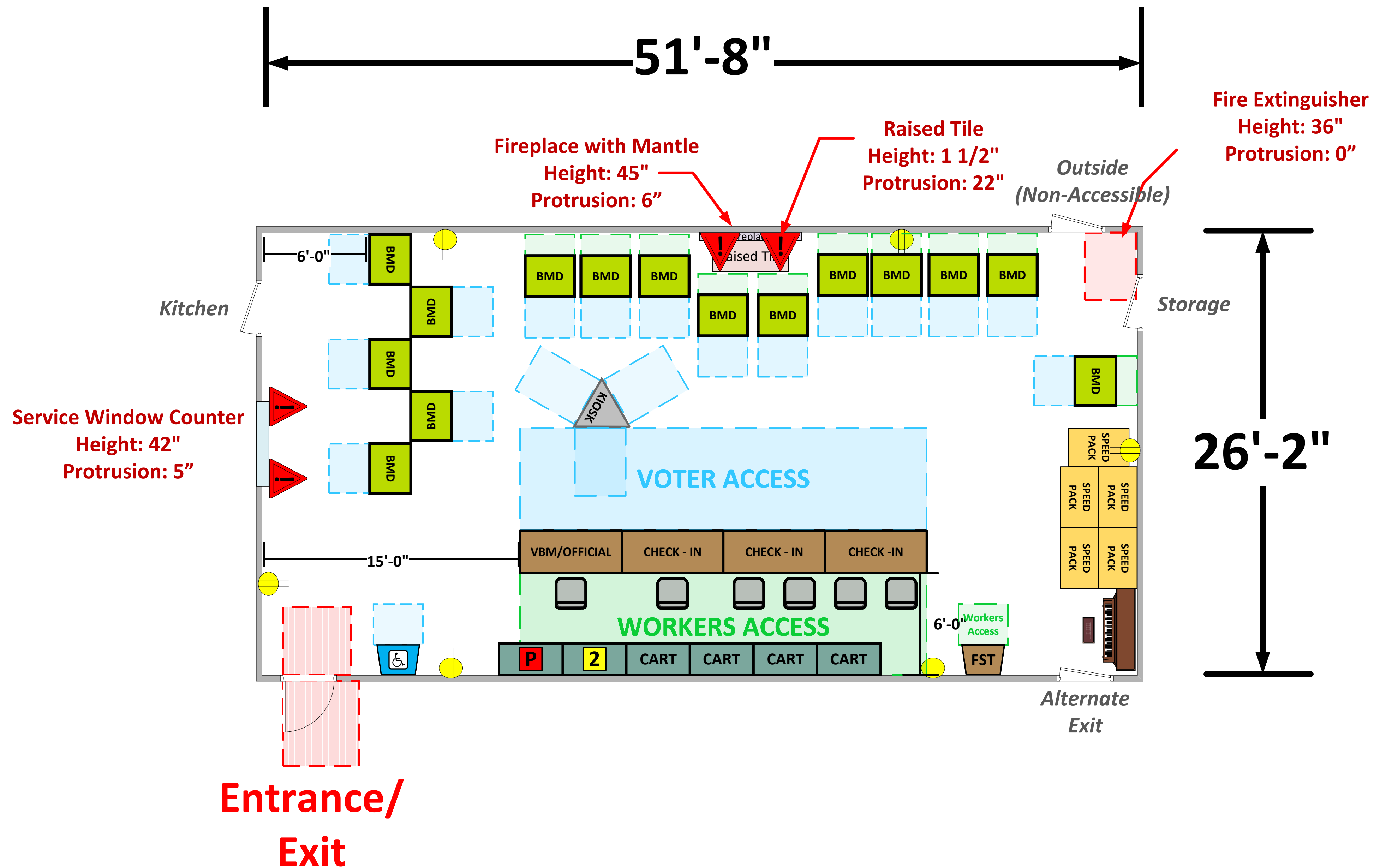



## Fellowship Hall (1,328 Usable Sq. Ft.)



## LEGEND

|                   |   |                   |
|-------------------|---|-------------------|
| Room Size         | Dimension:<br>51'8" x 26'2"   | Sq. Ft:<br>1,328' |
| Number of BMDs    | 15  |                   |
| POWER OUTLET      |  |                   |
| PROTRUDING OBJECT |  |                   |
| Do Not Block Area |  |                   |

**VCID 17880**  
**Church of the Living God**  
**CWFF Temple 44**

***Each chair at a CHECK-IN station equals one ePollbook***

|                            |                   |
|----------------------------|-------------------|
| Equipment By:              | Date:             |
| <b>Dustin Fuller</b>       | <b>08/26/2024</b> |
| Skeleton Drawn By:         | Date:             |
| <b>David Chaparro</b>      | <b>08/23/24</b>   |
| Scale:                     |                   |
| <b>1¼" inches = 1' Ft.</b> |                   |