

**Lobby,  
Room 100,  
Room 101  
(2,555 Usable Sq. Ft.)**

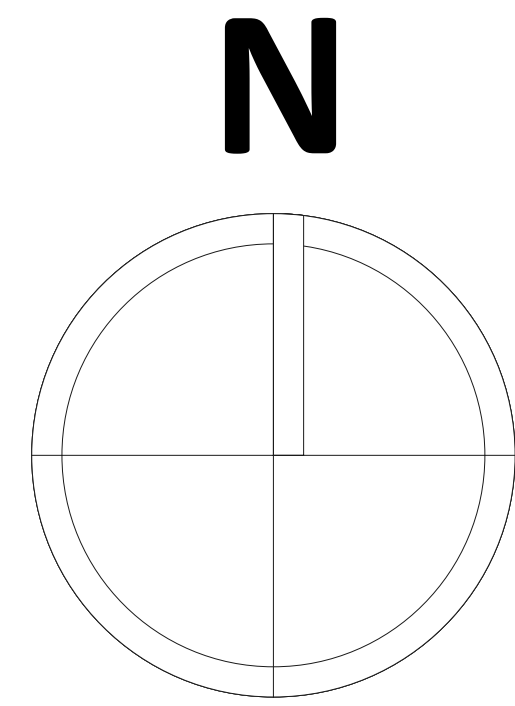

**LEGEND**

Room Size	Dimension: 48'10" x 64'8"	Sq. Ft: 3,157'
EPB	Primary:	Secondary:
BMD	Total: 15	Actual:
Circuits	Total:	Usable:
Floor Decals		
BALLOT MARKING DEVICE		
CHECK IN TABLE		
BMD CART		
BACKDROP		
KIOSK		
POWER OUTLET		
PROTRUDING OBJECT		
ROUTER		
POWER CORDS		

TITLE **Valley Korean United  
Methodist Church  
VC ID# 20892**

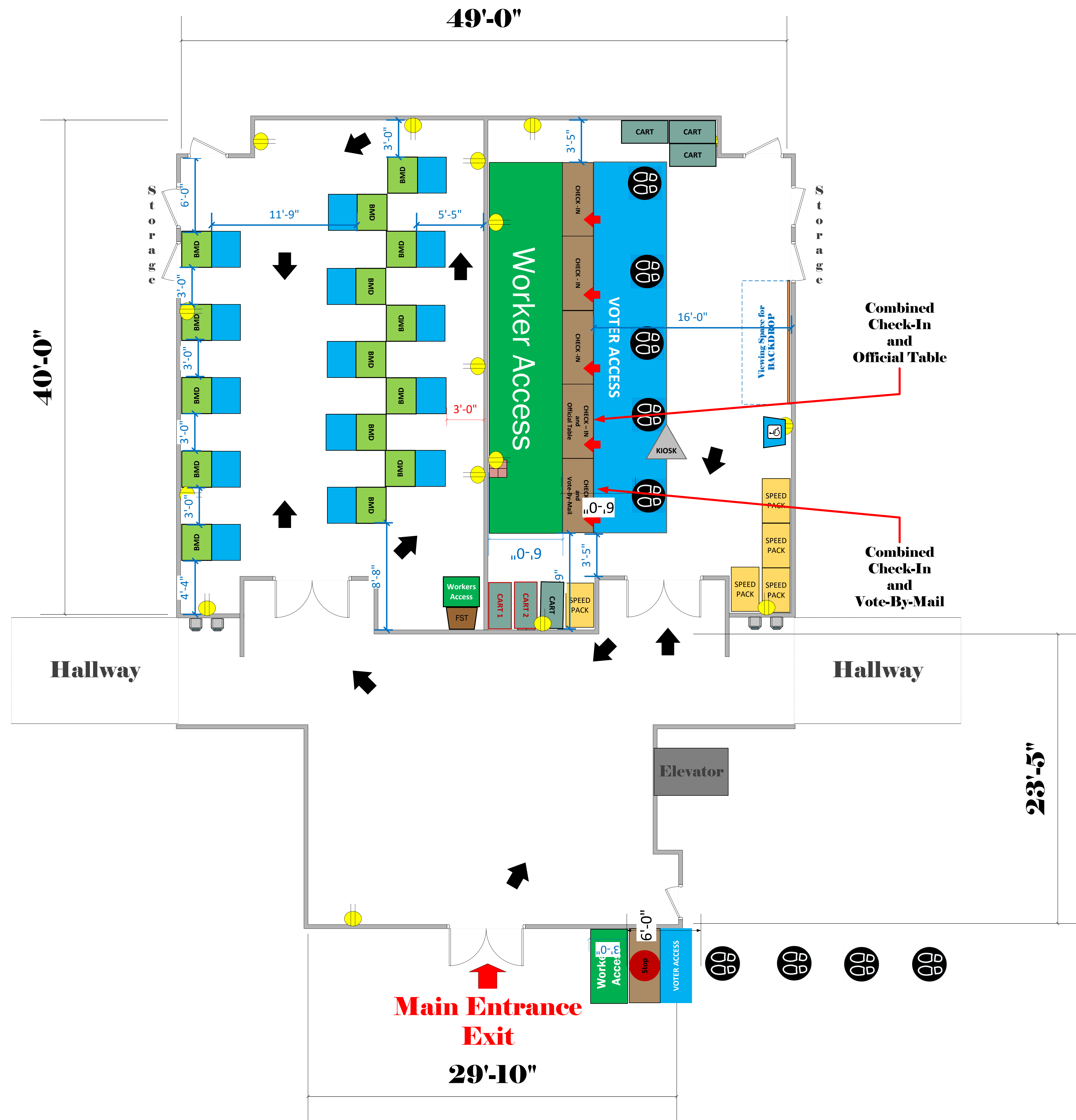

Combined  
Check-In  
and  
Official Table

Combined  
Check-In  
and  
Vote-By-Mail

**Main Entrance  
Exit  
29'-10"**

SCALE	1: 48
DRAWN BY	David Chaparro