

# Building D: MPR (2,096 Usable Sq. Ft.)

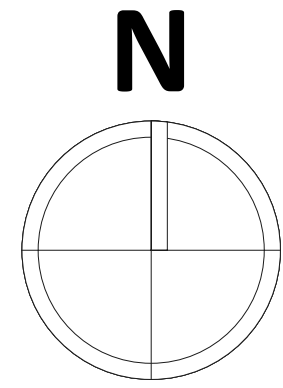

## LEGEND

Room Size	Dimension: 58' x 38'10"	Sq. Ft. 2,096'
EPB	Primary:	Secondary:
BMD	Total: 15	Actual:
Circuits	Total:	Usable:
Floor Decals		
BALLOT MARKING DEVICE		
CHECK IN TABLE		
BMD CART		
BACKDROP		
KIOSK		
POWER OUTLET		
PROTRUDING OBJECT		
ROUTER		
POWER CORDS		

**Jordon Plus  
VC ID# 20943**

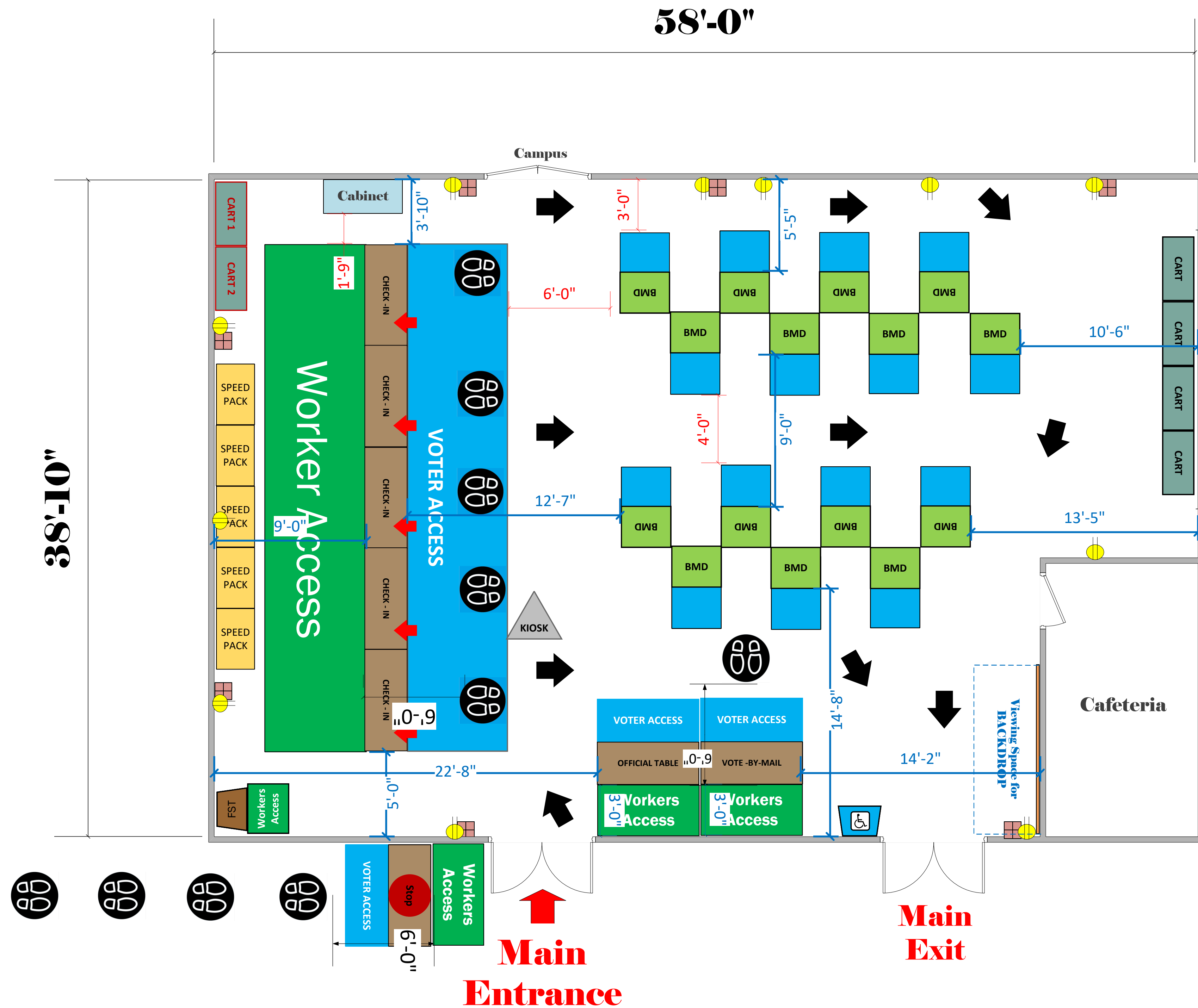

SCALE	1:48
DRAWN BY	David Chaparro