

**(1461 Sq. Ft)**

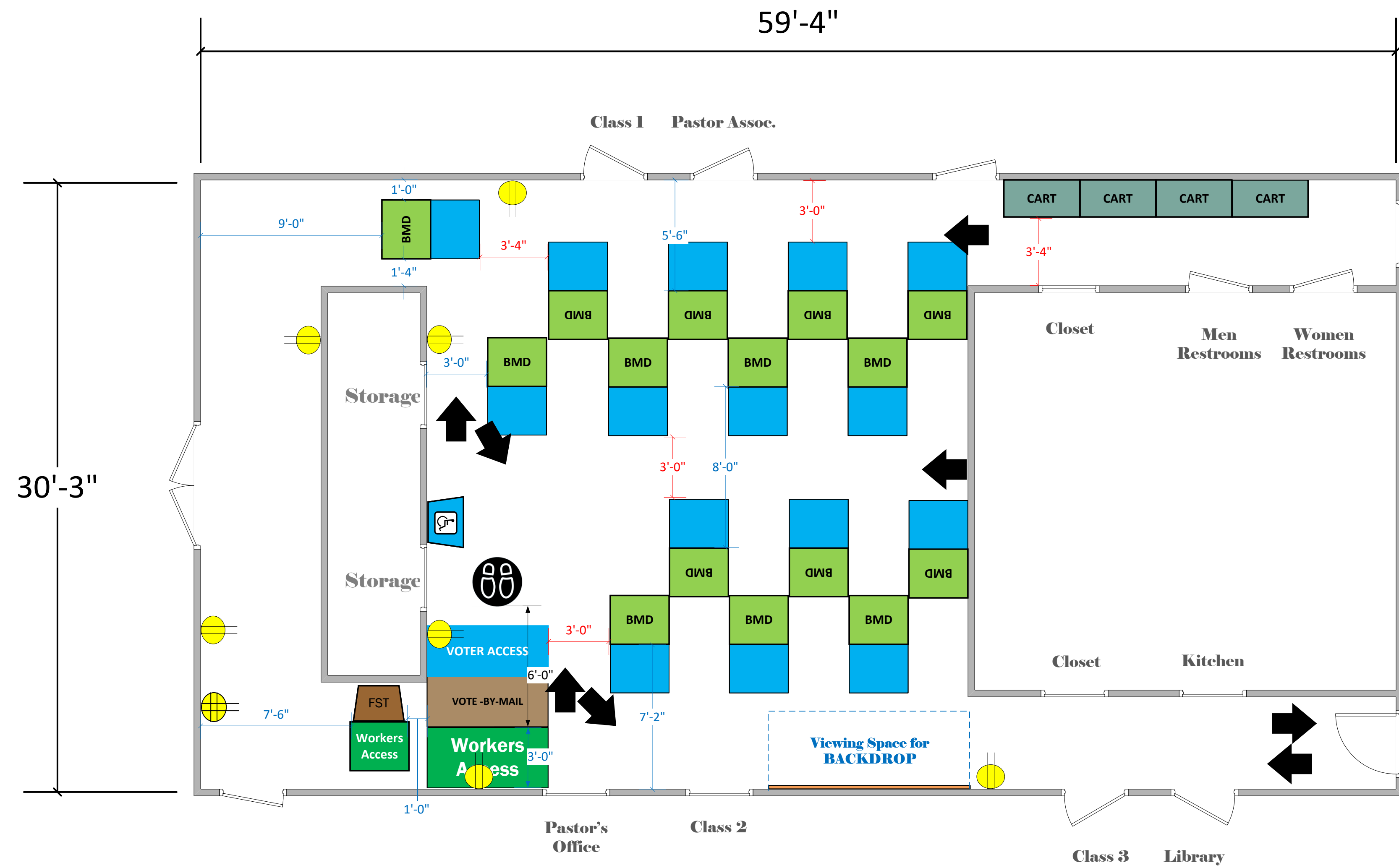

**Education Room 1  
VCID 20895  
(811 Sq. Ft)**

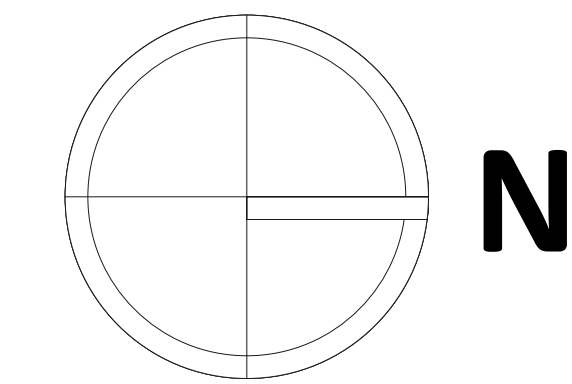

**LEGEND**

Room Size	Dimension:	Sq. Ft:	1461
EPB	Primary: 5	Secondary:	
BMD	Total: 15	Actual:	
Circuits	Total:	Usable:	
Floor Decals			
BALLOT MARKING DEVICE			
CHECK IN TABLE			
BMD CART			
BACKDROP			
KIOSK			
POWER OUTLET			
PROTRUDING OBJECT			
ROUTER			
POWER CORDS			

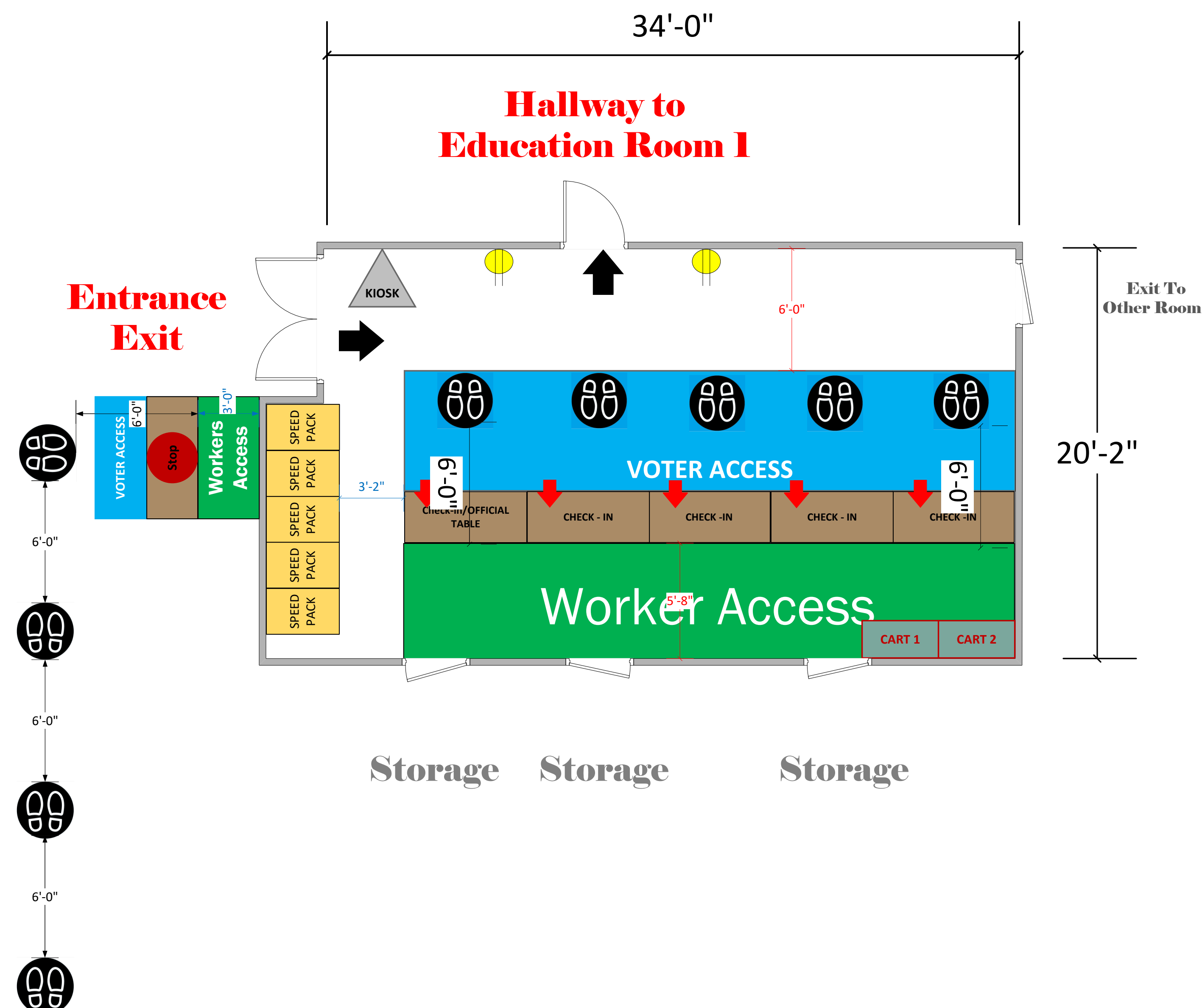

**Education Room 2  
VCID 21005  
(650 Sq. Ft)**

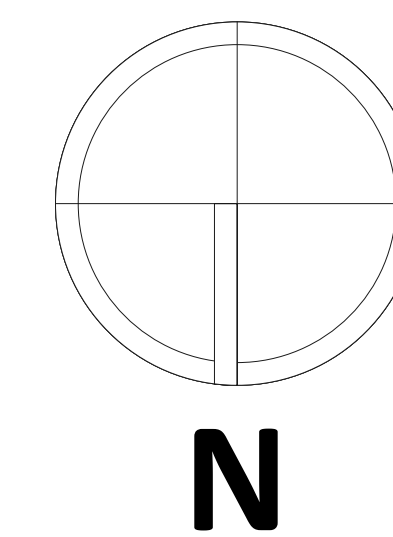

**Woodland Hills United  
Methodist Church  
VCID# 21016**

SCALE	1: 48
DRAWN BY	Cassandra Stipes