

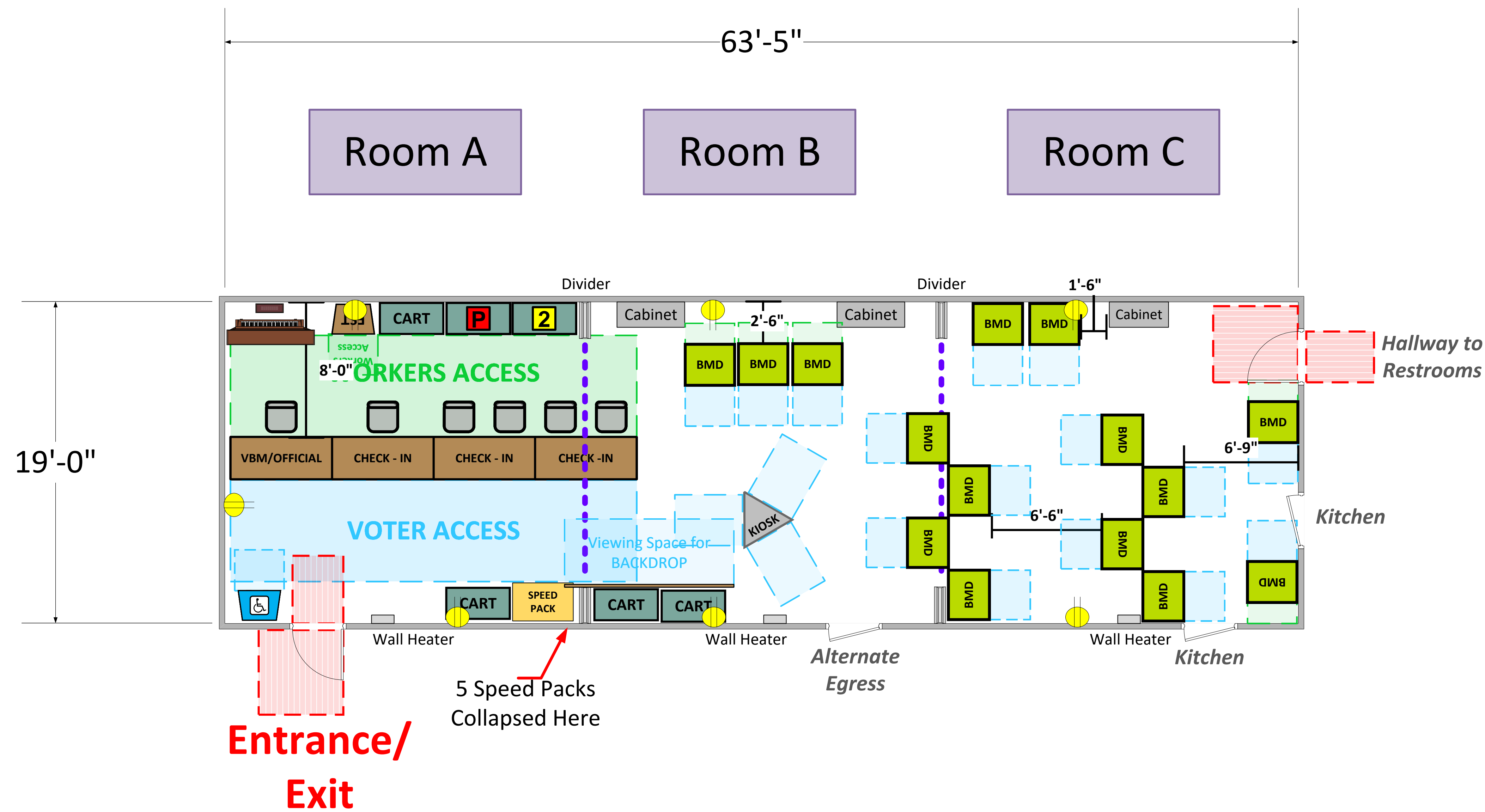



Robinson Hall
(Rooms A, B & C)
(1,220 Usable Sq. Ft.)



<u>LEGEND</u>		
Room Size	Dimension: 64'3 x 19'	Sq. Ft: 1,220'
Number of BMDs	15	
POWER OUTLET		
PROTRUDING OBJECT		
Do Not Block Area		
TITLE		
VCID 26316		
Morning Star Baptist Church		

Each chair at a CHECK-IN station equals one ePollbook

Equipment By:	Date:
Jaime Young	09/02/24
Skeleton Drawn By:	Date:
David Chaparro	08/28/24
Scale:	
1\4" inches = 1' Ft.	