

Multi-Purpose Room
(1,818 Usable Sq. Ft.)

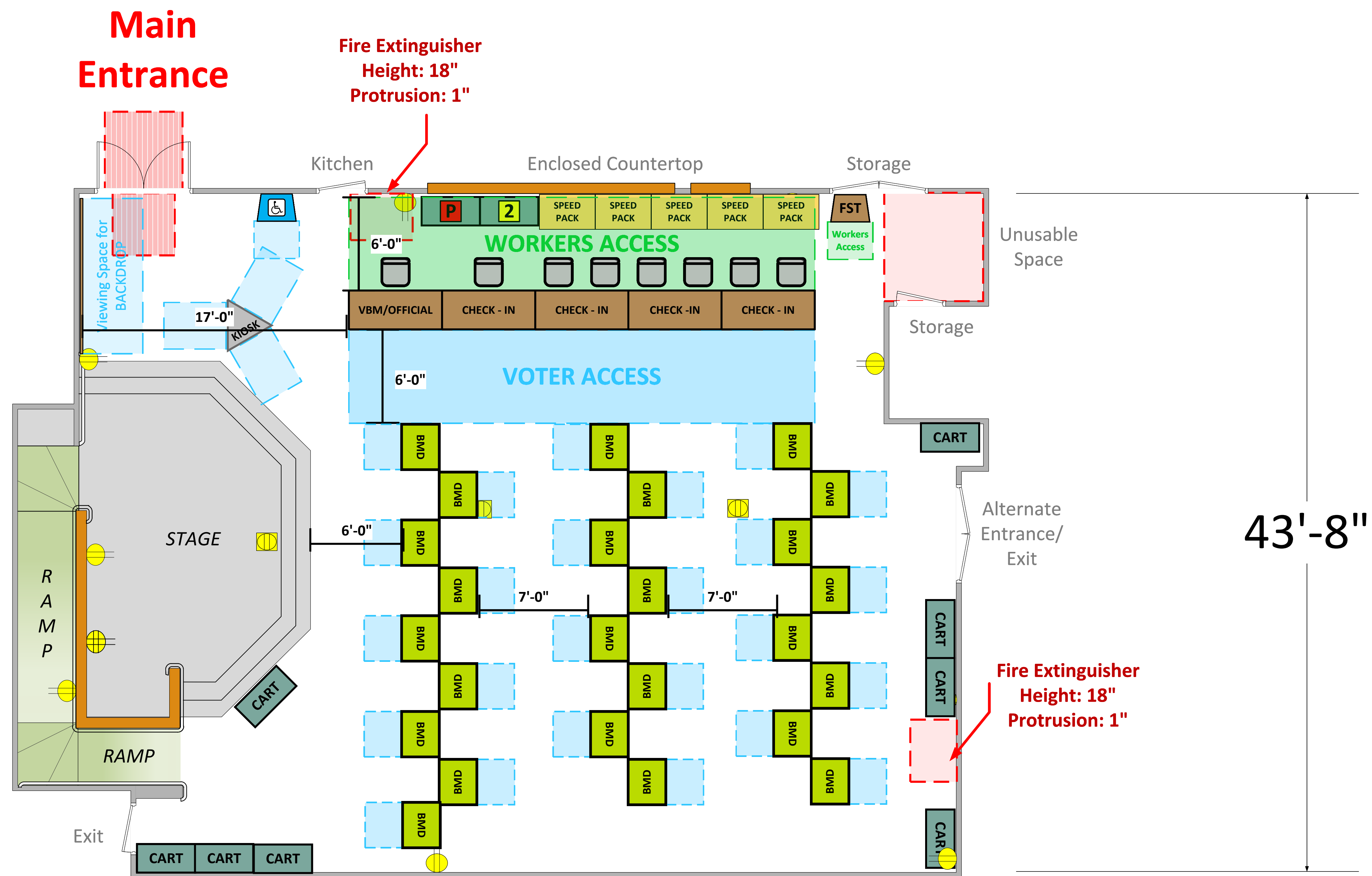

LEGEND

Room Size	Dimension: 43'8" x 41'7"	Sq. Ft: 1815'
Number of BMDs	25	
POWER OUTLET		
PROTRUDING OBJECT		
Do Not Block Area		

TITLE	35102 San Dimas Senior Citizens Center
-------	-------------------------------------------

Equipment By:	Ryan Rivas	Date:	09/25/25
Skeleton Drawn By:	Denise Rivera	Date:	9/22/25
Scale:	1¼" inches = 1' Ft.		

Each chair at a CHECK-IN station equals one ePollbook